



# SACRAMENTO STUDIO SHOWCASE

**BROADCASTING - STREAMING - VIRTUAL**

**"It is literally true that you can succeed best and quickest by helping others to succeed"**

In times of adjustment, pivot and reinvention, the collaboration of local small businesses, American Exposition Services, BP Productions, and Metro Media aim to do just that.



# SACRAMENTO STUDIO SHOWCASE

Together, our companies have collaborated to bring the Sacramento region a premier option for virtual broadcasts. State of the art equipment with our expert support provide the core necessity for your association, consumer show, school, corporate event, concert or other virtual meeting needs.

We will always provide a safe, clean and tidy environment for you and your staff. Cleanliness is of utmost importance and our venue will be cleaned and disinfected prior to your arrival. Daily cleaning is required as part of the agreement. The flexible space and our modular system await your customization. Our building offers easy drive-in or loading dock access, high speed internet, power and restrooms. We are located just off I-5 and I-80 freeways, 7.5 miles from the Sacramento International Airport and 8 miles from the Sacramento Convention Center.

Contact us to learn more about the studio and customized options:



1341 N Market Blvd. Suite 300  
Sacramento, CA 95834



[info@american-expo.com](mailto:info@american-expo.com)



916-925-3976



# SACRAMENTO STUDIO SHOWCASE

## Floor Plan

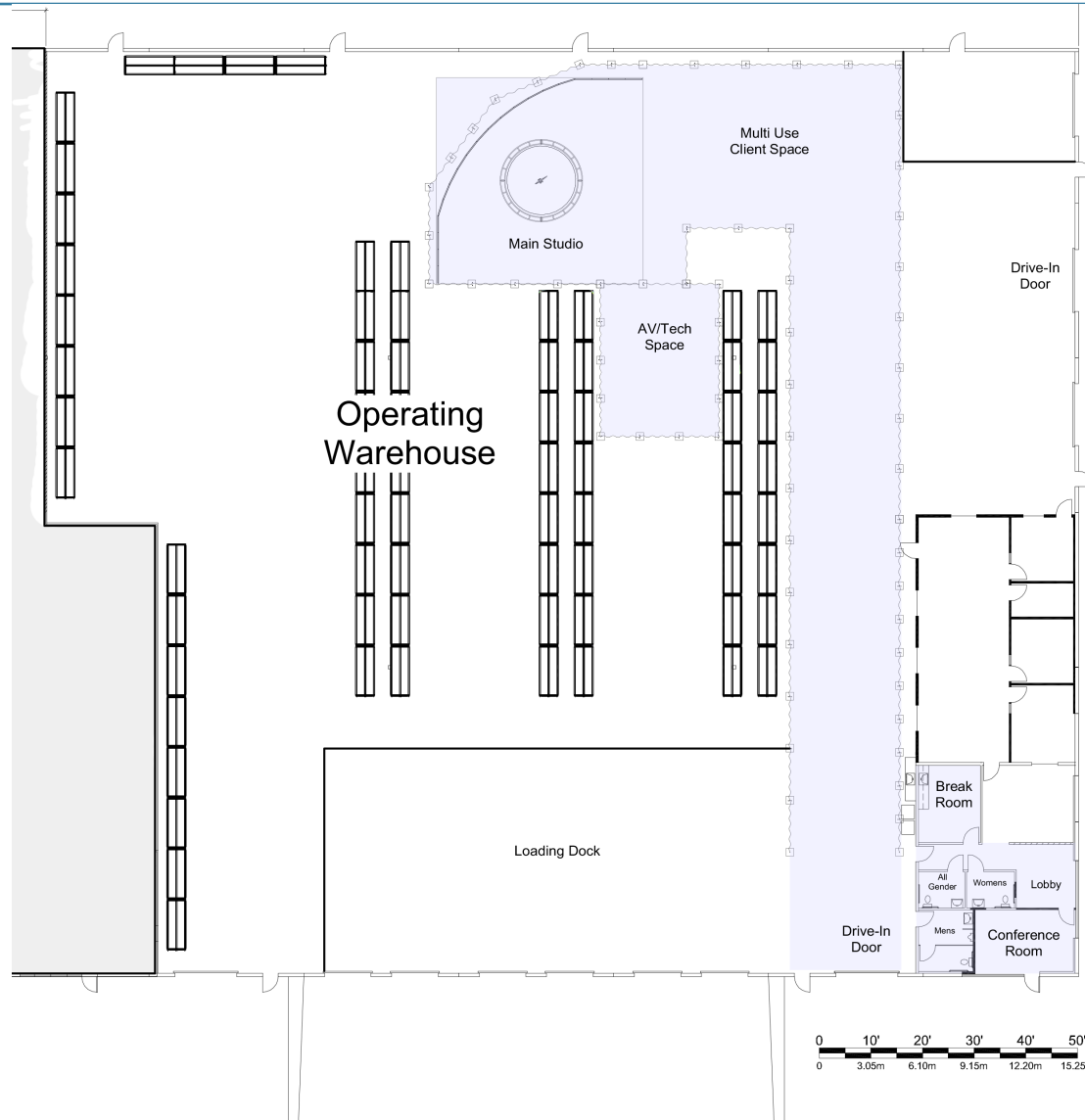





# SACRAMENTO

## STUDIO SHOWCASE

### Studio Specs

---

**Main Studio w/ LED Wall Backdrop** 40' x 40' x 26', LED wall 8'x40' - 3840x800

**Multi Use Client Area** 40' x 40' x 26'

**Conference Room w/ Monitor** 12' x 18' x 8'

**Break Room w/ Refrigerator, Microwave, Coffee Maker, Furnishings** 10' x 20' x 8'

**Green Room w/ Furnishings** 10' x 10' x 8'

**Power** 100 Amp 120/208V 3 Phase

**Broadband** Fiber Optic/Cable Hybrid 300 MB up / 25 MB down

**Restrooms** 1 Men / 1 Women / 1 All Gender

### Staffing

#### Rates

---

**Facility Manager (Required @ 8 hour minimum each day)**

\$60/hour

**Project Manager / Technical Director**

\$95/hour

**Studio Technicians**

\$65/hour

**Cleaning (Required)**

\$350/day

**Rigging / High Lift**

\$150/hour

**Electrician**

\$65/hour

Rates are per person, per hour. A 4 hour minimum charge will apply for each person per days worked. After 8 hours, staffing rates are calculated at 1.5 times the hourly rate.



# SACRAMENTO STUDIO SHOWCASE

## Studio Rates

Rates (10 hours)

### Main Studio

\$5000

Includes: Main Studio - carpeting, 8'x40' LED Wall w/ 4k processors, basic electrical, set lighting, wifi, tech area

### Multi Use Client Area

Included

Includes: Basic furnishings

### Conference Room w/ Monitor

\$500

Includes: Conference table for 8 persons, 60" wall mounted screen, basic furnishings

### Break Room / Green Room

\$500

Includes: Refrigerator, microwave, water cooler, Keurig coffee maker w/ Kcups, basic furnishings

### Power 100 Amp 120/208V 3 Phase

Included

Includes: Power to run studio package equipment and computers. Excess power can be supplied at time and materials

### Broadband Fiber Optic/Cable Hybrid 300 MB down / 25 MB up

Included

Includes: Access to wifi and hard line internet. Excess connections can be supplied at time and materials

## Optional Extras

Executive Furnishings - Premium Lighting Packages - Sound - Cameras - Video Editing - Graphic Printing - Set Design - Modular System Displays - Stage Risers - Tables & Chairs - Podiums - Plant & Floral - Flooring - Custom Branding - TV Monitors - Catering - Event Management - Virtual Meeting Software - Shuttle Service



# SACRAMENTO STUDIO SHOWCASE

## Facility Guidelines

---

Please read the following information, and sign and return the signatory page to our staff. This verification will confirm that you agree to all terms, conditions and policies set forth. This agreement must be received prior to any use of the studio; no exceptions. It is your responsibility to share this information with all vendors involved with your use of the studio.

### Hours and Delivery

- The studio is available for booking 7 days a week, 8:00am - 11:59pm. Studio hours outside of this timeframe will be billed at OT rates.
- Deliveries and pre-event site visits are available by appointment only; Monday - Friday.
- If your guests, staff or catering vendor(s) are on site, it will be considered part of the billing period.

### Security

- The facility is equipped with a security system and is included at no extra charge. Client shall remain responsible for their own equipment at all times and at no time shall liability for Client's equipment pass to American Exposition Services, BP Productions or Metro Media Productions. If overnight security is requested, Vendor shall be vetted and approved by AES in advance.



# SACRAMENTO STUDIO SHOWCASE

## Facility Guidelines

---

### Licenses and Permits

- Licenses and permits must be on file with American Exposition Services 14 days prior to booking dates.
- Each party shall maintain for the event: Workers Compensation Insurance, Commercial General Liability Insurance covering all operations, and Automobile Liability Insurance including coverage for all owned, hired and non-owned vehicles. All policies shall be in a minimum of two million dollars (\$2,000,000), except for workers' compensation, which shall be in the amount required by law. Please provide a COI for General Liability Insurance naming American Exposition Services, BP Productions and Metro Media Productions as additional insured.
- Other permits may be required based on the intended use of the space.

### Move-In and Move-Out

- Loading and Unloading can take place via two separate drive-in, grade level door or the loading dock. Drive-in vehicles are limited to 26' box trucks and the loading docks with levelers can accept up to 53' trailers with tractors. Forklifts and drivers are available at an hourly rate upon request.
- Client must supply a load-in and load out manager.
- Client vehicles entering the facility must be moved outside immediately after the loading or unloading occurs. We will not accept any overnight parking inside the building.
- Overnight vehicle parking is available outside the facility, however all liability for vehicle and contents remain with the owner of the vehicle.



# SACRAMENTO STUDIO SHOWCASE

## Facility Guidelines

---

### Overtime

- Daily studio rates quoted within this guide are based on a 10 hour work day. Events lasting longer than 10 hours in a given day are subject to an overtime rate 1.5 times the hourly rate. (Ex. Daily rate divided by 10 hours x 1.5 = OT hourly rate)
- After 8 hours, staffing rates are calculated at 1.5 times the hourly rate.

### Other Terms & Conditions

- Please leave the studio as it was when you arrived. Excess waste and/or cleaning shall be invoiced accordingly.
- Deposits shall be paid in advance and remaining balances are due prior to the first day of the event; no exceptions. Additional charges and adjustments will be settled within 15 days of close of the booking. Delinquent accounts will be charged an interest rate of 1.5% per month.
- Where applicable, California sales tax will apply at the local prevailing rate.

### Acceptance

This is to certify that I have read and agree to the terms and conditions set forth in this document.

---

Client's Signature and Date

---

Client's Name (please print)